

No 10

No 848 Prot. Ep. Acady. Philada

No 858 Prot. Ep. Acady. Philada

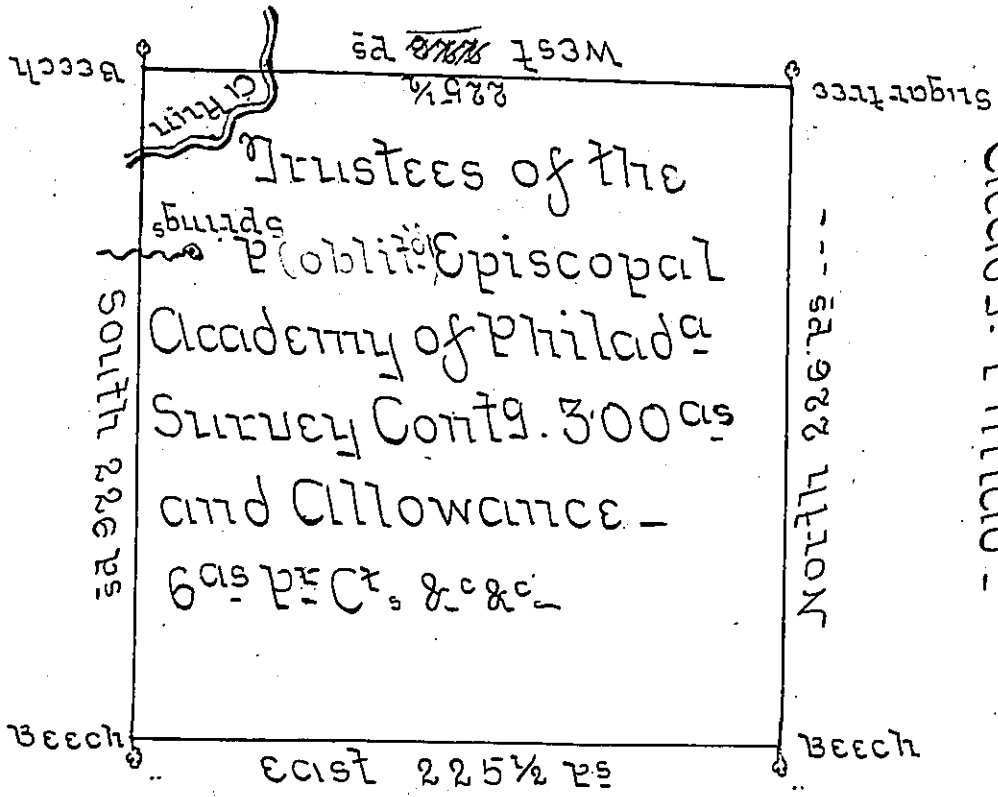

No 844 Prot. Ep. Acady. Philada

No 850 Prot. Ep. Acady. Philada

A Draught of a tract of land situated in the late purchase, on the head waters of the East branch of Pine creek, and about twenty five miles distant from the West branch of Susquehanna - Surveyed for the Trustees of the Protestant Episcopal Academy of Philada - September - one thousand seven hundred and eighty eight on a Warrant numbered Eight hundred and forty nine, containing three hundred acres and Allowance -

Saml Edmiston

D. Sur.

John Lukens Esq }
Sur Genl - }

IN TESTIMONY that the above is a copy of the original remaining on file in the Department of Internal Affairs of Pennsylvania, made conformably to an Act of Assembly approved the 16th day of February, 1833, I have hereunto set my Hand and caused the Seal of said Department to be affixed at Harrisburg, this Eleventh day of October 1904.

Joseph P. Pennington
Secretary of Internal Affairs.